

GLOBAL88
CITY CENTRE
SECTOR 88A GURUGRAM



CORPORATE OFFICE

UNIT NO. 903-905, C-WING, JMD MEGAPOLIS
SOHNA ROAD, GURUGRAM - 122018

CONNECT WITH US

PH. +91 - 7290 858 585 (CORPORATE SALES)
EMAIL | GH88A@BREEZBUILDERS.COM



HARERA LICENCE NO. 07 OF 2022

A PROJECT BY

BREEZ
BUILDERS & DEVELOPERS



Disclaimer:- The drawings and graphics apart from actual images, given in this brochure is for preliminary purposes. Further the Promoter/Architect reserves the right to add / delete specifications mentioned, if so warranted by the circumstances.

Elevate your Business...



AT BREEZ WE ARE, NOT JUST CREATING HOMES BUT CREATING A DESTINATION.

Over the years we have developed a keen understanding of people, their values, expectations of a home and all that goes into creating a world of special experiences that they will cherish.

With a successful background that goes back a decade, our business is poised to set its sights even higher. Beginning with achieving new milestones in a diverse set of projects through Gurugram, Haryana, we only plan to fly higher. Persistent long term planning, thinking out-of-the-box and unquestionable service has set us apart, not just as a company you work with but as a community you can bank on.

We look forward to helping you achieve a smooth and easy transition into the field of real estate.



Department of Town & Country Planning CERTIFICATE OF RECOGNITION

On-Time Delivery of Affordable Housing Project

Award Presented By
Sh. Manohar Lal Khattar
Hon'ble Chief Minister Haryana

100%
ON TIME COMPLETION
**SUCCESSFULLY
DELIVERED PROJECTS**

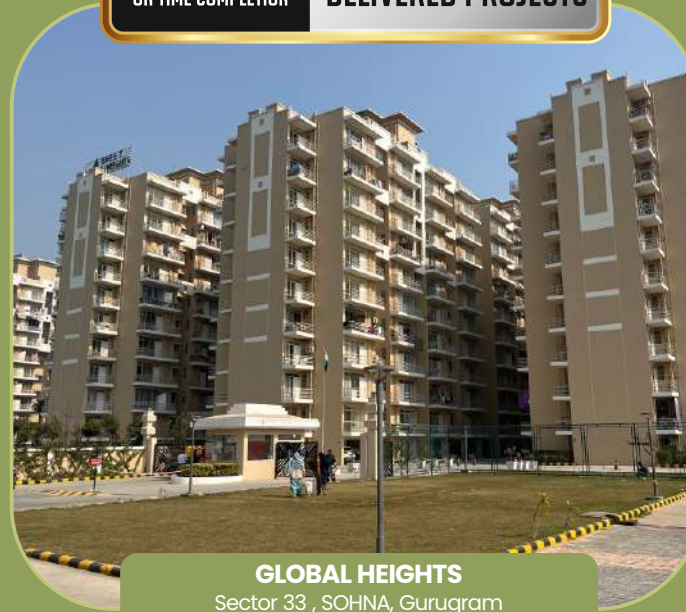

GLOBAL HEIGHTS
Sector 33 , SOHNA, Gurugram



GLOBAL HILLVIEW
Sector 11 , SOHNA, Gurugram

GLOBAL HEIGHTS

PARTNERING WITH THE BEST

With a host of ambitious projects rapidly taking shape, today 'BREEZ' as a brand stands at the threshold of bringing in more landmarks and more innovative concepts of home, retail and business. The future beckons and Brand 'BREEZ' is ready for it

**COMMERCIAL & RESIDENTIAL
PROJECTS UNDER CONSTRUCTION**



GLOBAL CITY CENTRE - 2
Sector 33 , SOHNA, Gurugram

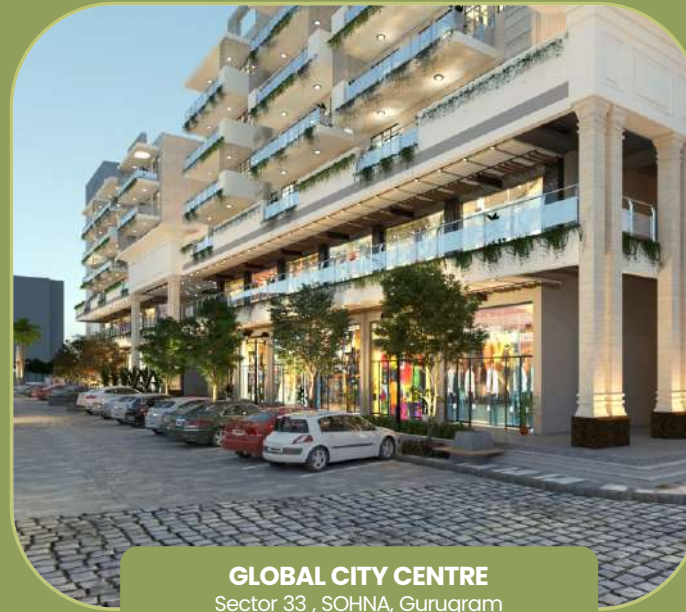

GLOBAL CITY CENTRE
Sector 33 , SOHNA, Gurugram



GLOBAL PLAZA
Sector 11 , SOHNA, Gurugram



FLORA AVENUE 33
Sector 33 , SOHNA, Gurugram

High-street Retail Experience

Modern architecture marries upscale designs to create a holistic environment, ensuring that you are still in the lap of nature while simultaneously enjoying a modern lifestyle

A rare business opportunity poised to reap long-term profits and commercial success because of its coveted location, brilliant designs and smartly conceived amenities.

Yes, you read it right! Global City Centre 88A is the happening business destination coming up in the buzzing area of sector 88A, Gurugram. With magnificent glass facade that makes an imposing style statement, Infinity plaza presents you an excellent range of retail shops that enjoy best of location and facilities for your business.

Shops & Retail Spaces Empowering Ambitions to become a successful reality



THE WINNING LOCATION

- Proximity to the planned Metro Station.
- Dwarka Expressway just few meters away(walking distance).
- Connected by 3 National Highways: Delhi-Jaipur Highway (NH 48), Dwarka Expressway(NH 248BB) & Pataudi Road (NH 352W)
- Emerging as one of the prominent destinations for IT/ITeS companies.

**A profitable business destination,
sector 88A Gurugram**

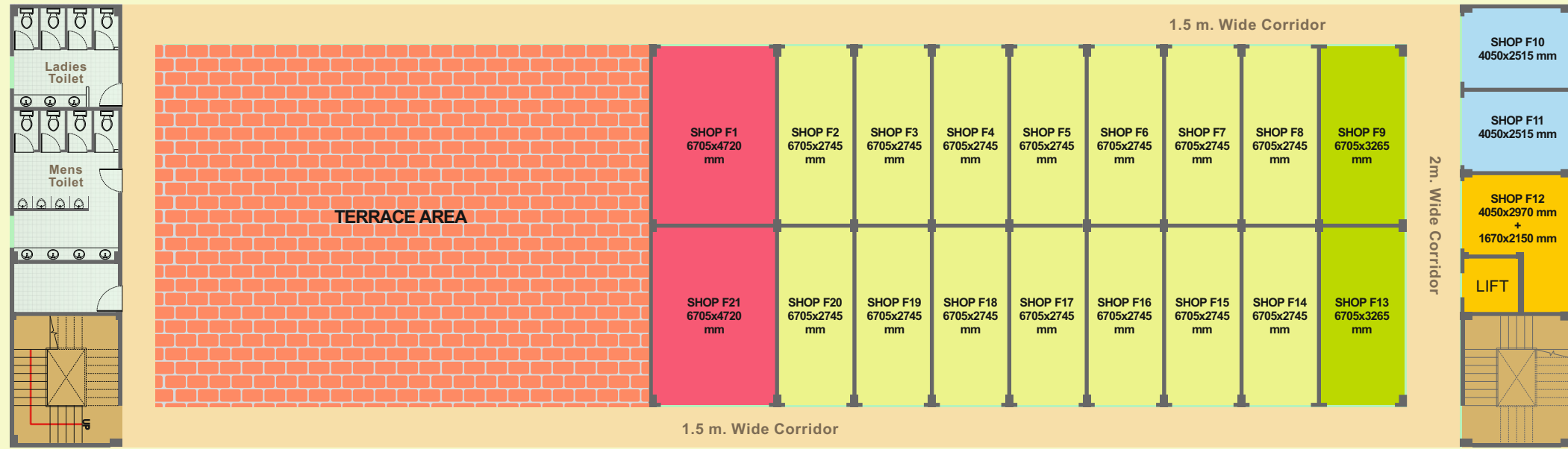

FIRST FLOOR PLAN COMMERCIAL - 1

GROUND FLOOR PLAN COMMERCIAL - 2
Global City Centre 88A



CLUSTER LAYOUT PLAN COMMERCIAL GLOBAL CITY CENTER 88A

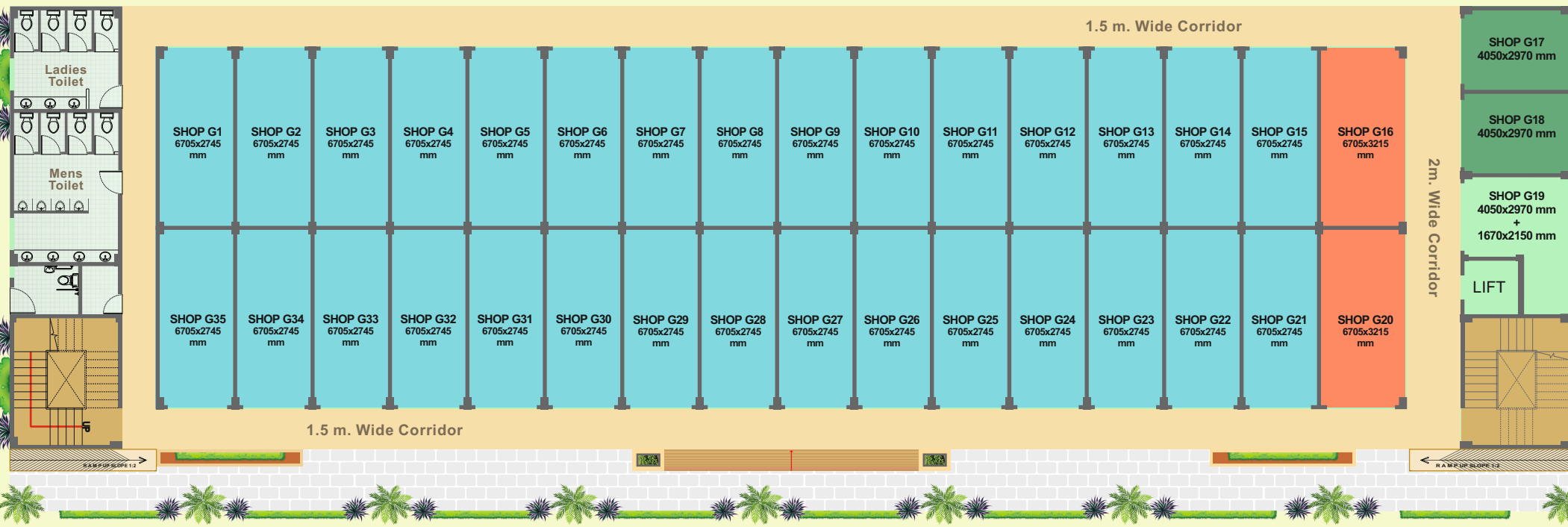

GROUND FLOOR PLAN COMMERCIAL - 1

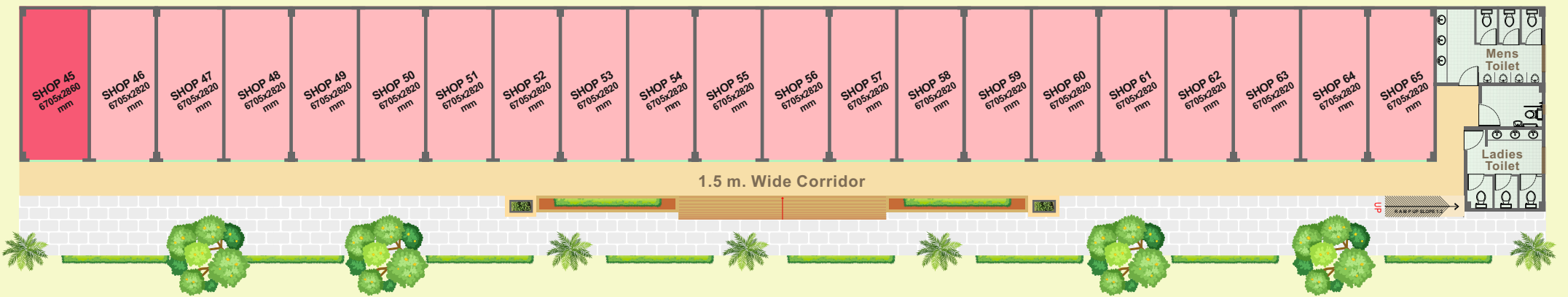

GROUND FLOOR PLAN COMMERCIAL - 3
Global City Centre 88A



GLOBAL CITY CENTER UNIQUE BENEFITS

Convenient. Classy. Commercial

- Effective planning allows street level entrance overlooking pedestrian walkway all around the complex
- Shops for International Style retail format with independent service utilities
- The project is surrounded by high dense residential sectors
- Provision of Wet Points in all Units
- The complex is under construction and floor-wise lease/sale options are available
- Independent shops with low maintenance module & excellent returns
- Shop modules offer flexibility in sizes – each block can be combined together if desired

A HOST OF FACILITIES FOR SMOOTH BUSINESS OPERATIONS

Design Specifications

- Large store fronts & glazing area for units
- Exterior: Combination of glass, marble, stone, granite, tiles, HPL, ACP & painted surface
- Exterior Flooring: Combination of Granite, Tiles, Stone & Interlocking tiles
- Lobbies: Combination of stone, tiles, HPL, ACP painted surface
- Unit Finishes: Plastered walls with exposed RCC slabs
- Washroom: Combination of Tiles/ Painted surface on DADO, Stone/Tile Finished Countertops, HPL/Laminated partition door
- Structure: Earthquake resistant RCC structure
- Fire & Life Safety: Provided as per norms.



ATM



Vegetables Store



Convenience Store



Cafeteria



Retail Shops

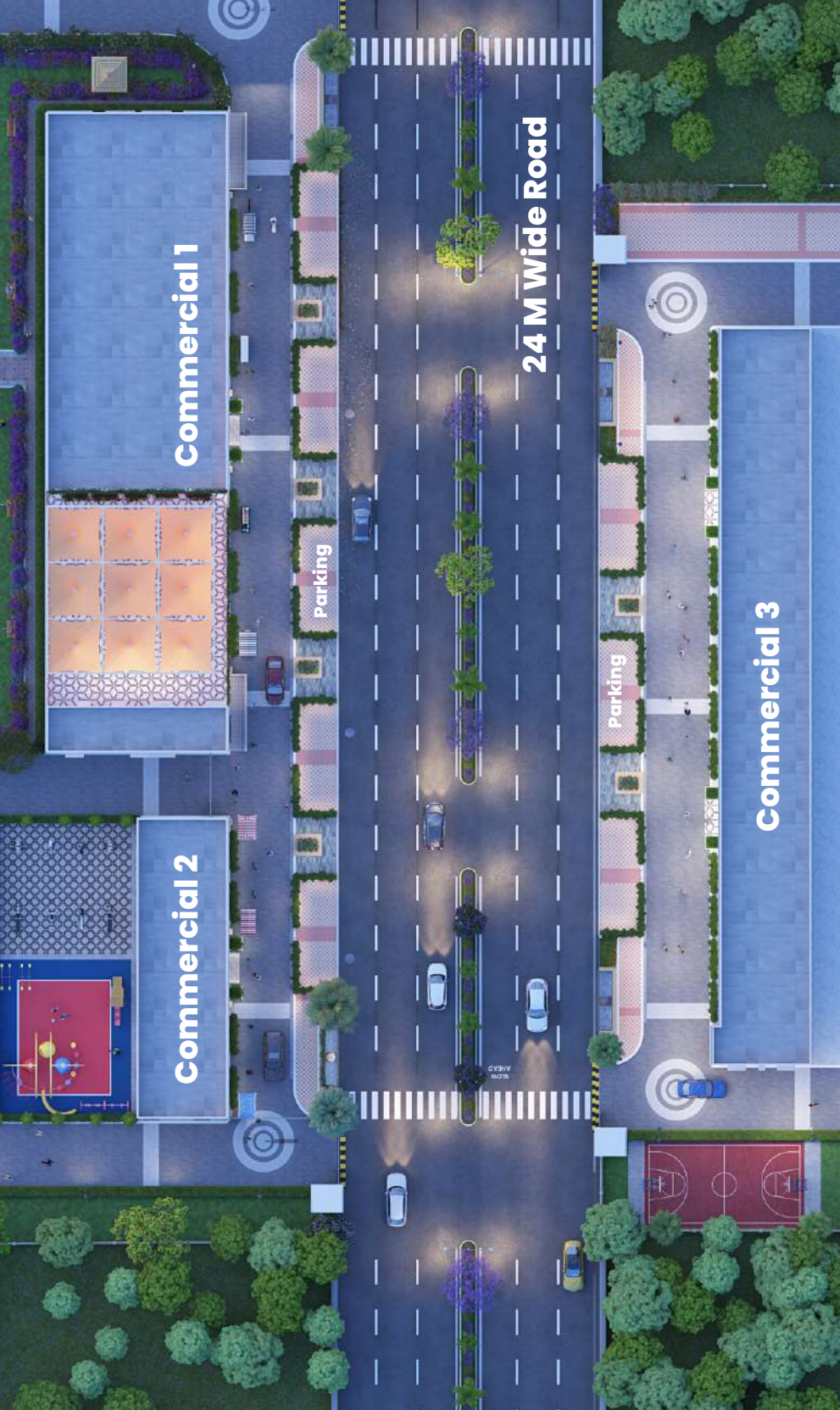

Live SEAMLESSLY

The special ingredient for a special offering,
a retail space that is ideally located...

There is no doubt about the fact that in case of the retail/business complex, the location plays the main role. Marked with the presence of most upscale residential projects in the vicinity, shops at Global City Centre 88A are entitled to the lucrative catchment, while enjoying proximity to Dwarka Expressway.

Here are some of the location advantages of Global Heights Sector 88A, Gurugram project:

- Proximity to the planned **Metro Station**.
- **Dwarka Expressway** just few meters away(walking distance).
- **Connected by 3 National Highways:** Delhi-Jaipur Highway (NH 48), Dwarka Expressway(NH 248BB) & Pataudi Road (NH 352W)
- The location is close to Sector 88, a commercial sector occupied by **DLF for Cyber City 2**.
- Emerging as one of the prominent destinations for **IT/ITeS companies**.

Key Locations distances in nearby vicinity

- | | |
|--|--|
| - Airport 20 minutes | - Gurugram ISBT 15 minutes |
| - Railway Station 06 minutes | - DPS School 05 minutes |
| - Cyber Hub 20 minutes | - Hospitals 15 minutes |
| - Manesar IMT 10 minutes | - HUDA City Center 25 minutes |
| - AIIMS OPD 10 minutes | - RPS International School 5 minutes |
| - Matrikiran by Vatika School 7 Mins | |

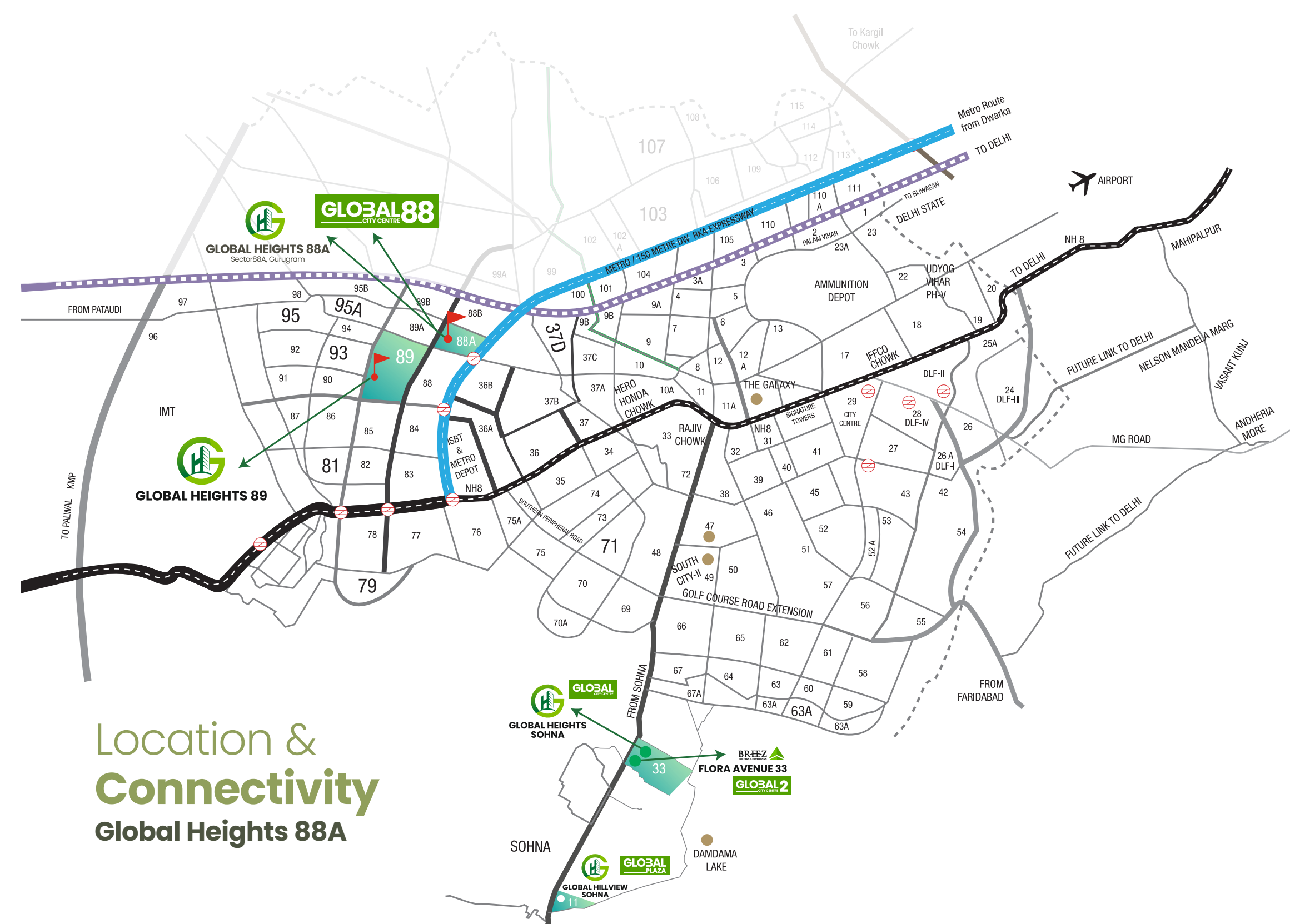

Location & Connectivity Global Heights 88A